

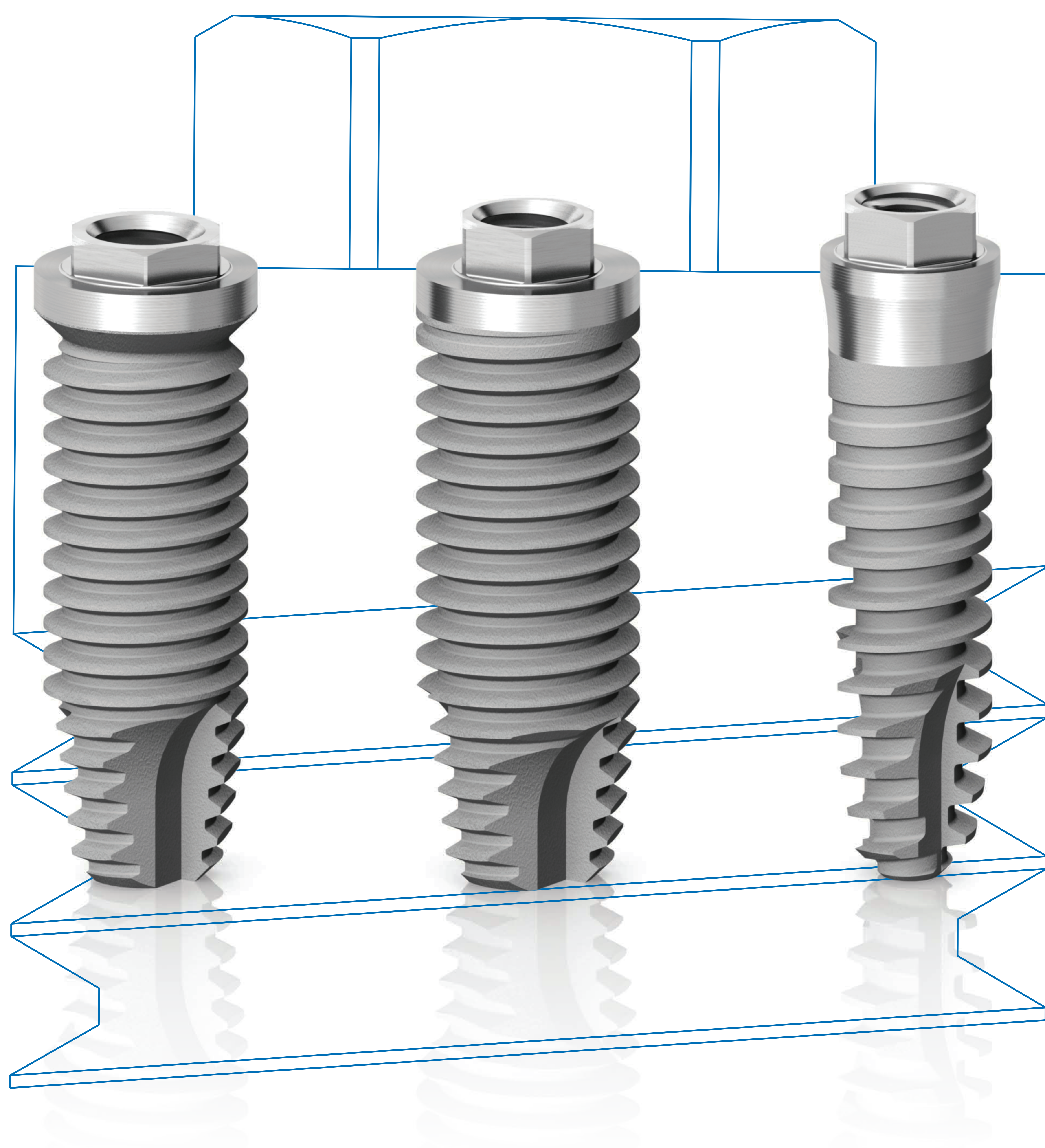

# sweden & martina

## I M P L A N T O L O G Y



## OUTLINK<sup>2</sup>

The prosthetic ease of the **external hex** together with the clinical versatility documented by many scientific articles.

**Multifunction mounter:** carrier, transfer for the impression phase, prosthetic post.

Availability of **Shorty implants**, with reduced height of 5.00, 7.00 and 8.50 mm.

New **Outlink<sup>2</sup> Slim** implant, with 3.00 mm diameter and transgingival neck.